



## Fire alarm systems Frame for flush mounted EBL512, 1568

- Same colour as the c.i.e. housing
- Prepared for simple mounting

### General

The frame **1568** is used when a c.i.e. **EBL512** shall be flush mounted.

The frame is made of metal and has the same grey colour as the EBL512 housing.

The frame width is 30 mm on all four sides.

In order to make it possible to open the door, the housing has to be placed approx. 60 mm out from the wall. Behind the housing there might be need of space for some mounting device. See figure to the right.

The frame is prepared with mounting holes ( $\text{Ø}=6$  mm), two holes on each side and one hole at the top and at the bottom. It is also prepared for access to the EBL512 housing's knock-outs for cable entries. See figure on the opposite page.

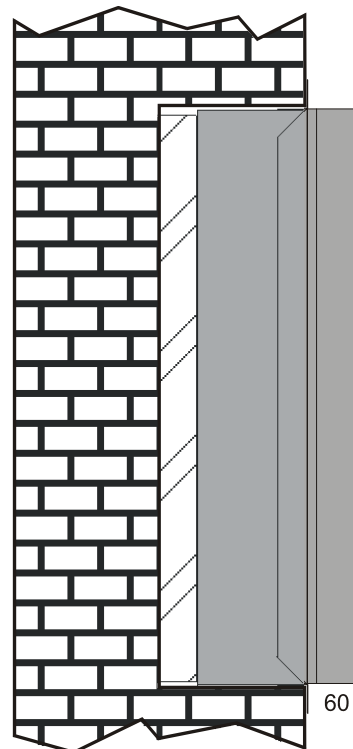

Type number

1568

Frame for flush mounted EBL512.

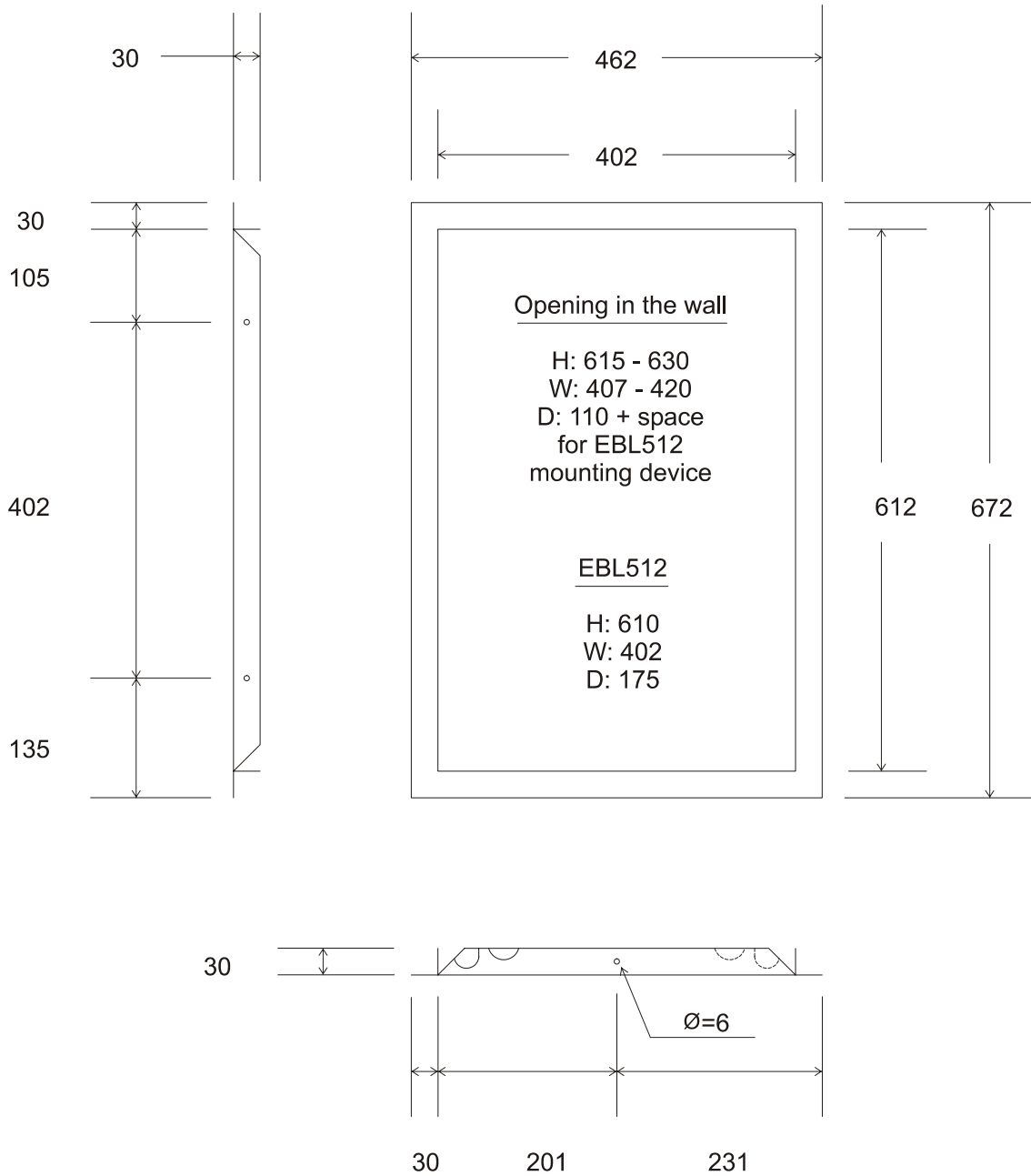

Technical data

Size H x W x D (mm)	672 x 462 x 30 See also the figure above.
Weight (g)	1365
Construction / Colour	Metal / Light grey (NCS S1500-N, PMS Cool Grey 2)

All technical features and data are subject to changes without notice, resulting from continuous development and improvement.

Product Leaflet	Date of issue	Revision / Date of revision
MEW00440	2003-09-09	1 / 2005-12-06